

MOBILEPILOT

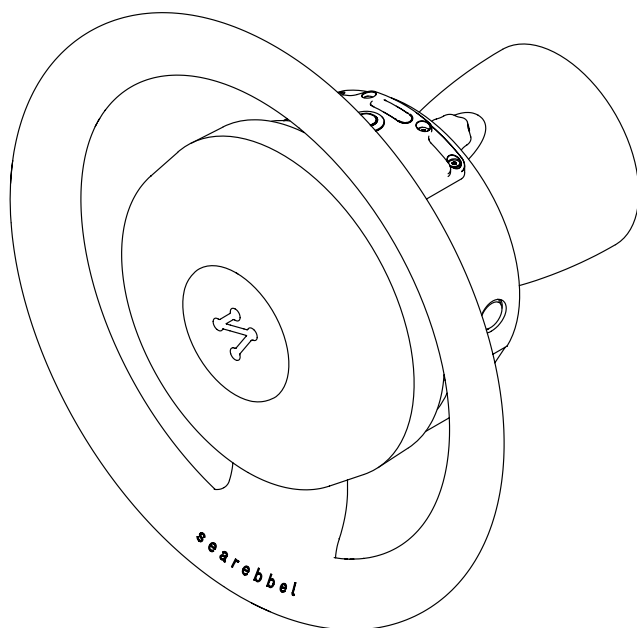

IDIOMAS / LANGUAGES

- ES pg.3
- EN pg.12



INDEX

1. MobilePilot Description	pág.13
2. Legal Information, Warranty & Regulatory Compliance	pág.15
3. Packaging	pág.15
4. MobilePilot Installation	pág.16
5. Navigating with MobilePilot	pág.20
6.NMEA 2000	pág.21

Abbreviated version of the manual.

For the full documentation, visit <https://www.searebbel.com/user-manuals/>
or scan the QR code below.



WARNING:

The MobilePilot system does not replace the active, constant, and direct supervision of the person responsible for operating the vessel.

1. MOBILEPILOT DESCRIPTION

- 1 MOBILEPILOT
- 2 BATTERY
- 3 COVER
- 4 BUTTON POWER ON/OFF
- 5 BUTTON AUTOPILOT ON/OFF

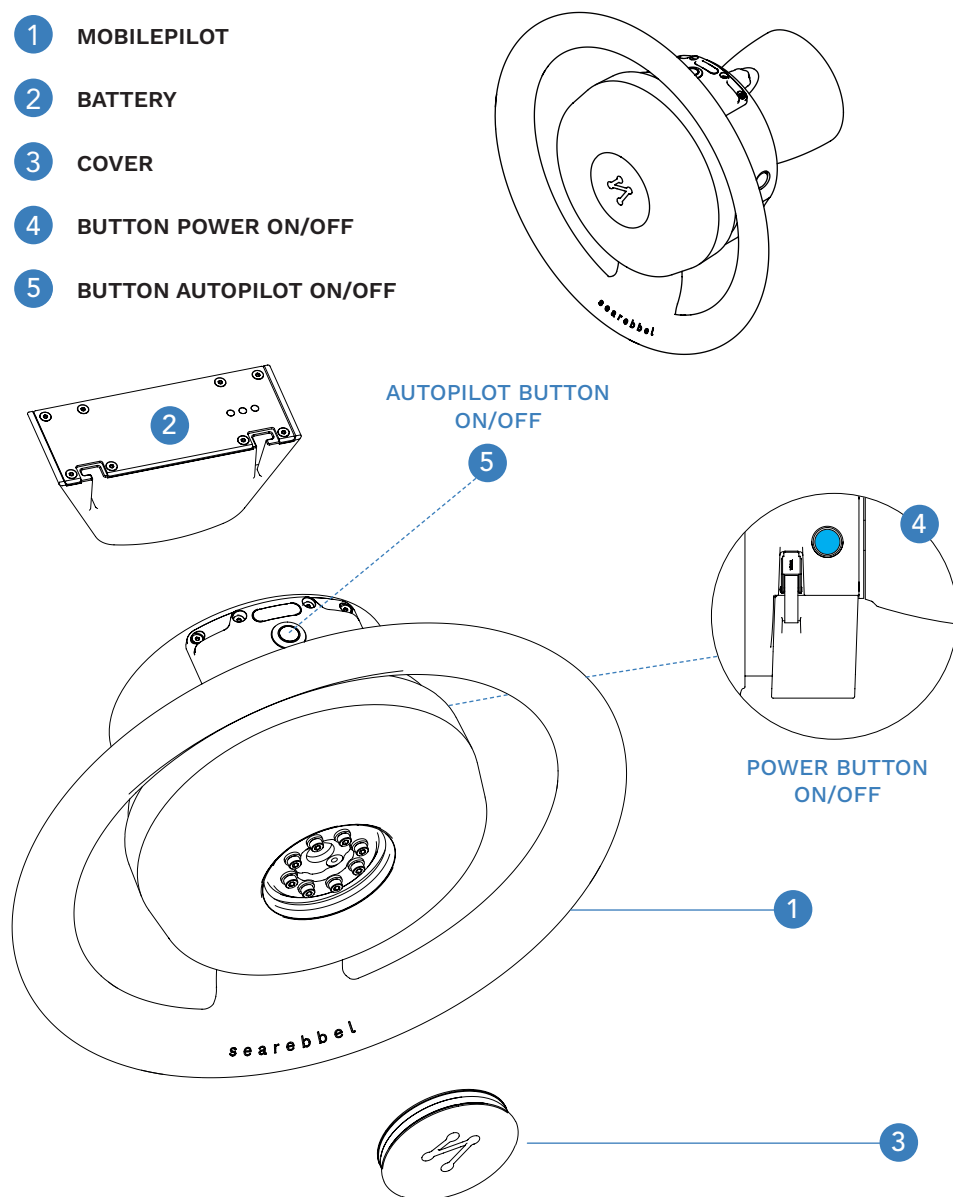



MobilePilot is a smart assistant navigation system that transforms a vessel's traditional helm into a motorized wheel that can be controlled via mobile devices. This innovative product is designed to simplify navigation and enhance onboard safety.

TECHNICAL SPECIFICATIONS

The product label is located on the rear side of the MobilePilot control unit and is easily visible upon removing the battery.

Technology	Frequency band	Effective Isotropic Radiated Power (EIRP)
Bluetooth	2402 / 2480 MHz	-12 / +9 dBm
Wi-Fi	2412 / 2484 MHz	TX 19.5 dBm
GNSS	1575.42MHz, 1602 MHz	Pasivo: N/A

BATTERY: LI-ION 14.8V 3000MAH.

MODEL: MOBILEPILOT AUR

CHARGER: DC 5V-24V 3,5 A (USBC-BINDER)

VOLTAGE: 12VDC / 24VDC - 3,5 A

OPERATING TIME DURING TX: 2-5 H

WEIGHT: 9.95KG

STANDBY TIME: 24 H

DIMENSIONS: 350 X 132 MM

OPERATING TEMP. RANGE: -25/+40 (°C)

IP67 RATED

This device may collect and store user data to ensure proper operation and improve the user experience. Full details on the processing of personal data are available in the privacy policy, accessible through the app and the official Seare-bbel website.

BEFORE USING THE MOBILEPILOT

- This device contains an internal battery. Do not expose it to heat or moisture, and do not tamper with it. Dispose of it according to local regulations.
- Upon receiving the product, ensure that the packaging shows no damage that could have affected the device inside.
- Once the product has been unpacked, we recommend keeping the packaging for a reasonable period until verifying that the steering wheel works properly.
- Always disconnect the power supply before performing any maintenance, adjustment, or installation tasks.
- This device must be operated exclusively by individuals with knowledge of navigation and maritime safety, holding the certifications or licenses required by applicable legislation.
- Do not use under adverse weather conditions, poor visibility, or any situation that could compromise safety during navigation.



2. LEGAL INFORMATION, WARRANTY & REGULATORY COMPLIANCE

LIMITED WARRANTY

This product is covered by a warranty in accordance with the applicable laws of your country.

By purchasing and using the MobilePilot system, the user accepts the warranty conditions, legal notice, and liability disclaimer applicable to this product.

To review the full warranty terms, liability limitations, legal notices, and conditions of use, please refer to the extended manual available at: <https://www.searebbel.com/user-manuals/>

SEAREBBEL S.L. hereby declares that the MobilePilot Aur v1.0 product complies with the essential requirements and other relevant provisions of Directive 2014/53/EU.

The full text of the Declaration of Conformity is available at the following internet address: <https://www.searebbel.com/es/declaracion-de-conformidad-ue/>

Disposal and Recycling Information:

This crossed-out wheeled bin symbol indicates that the MobilePilot product should be recycled or disposed of separately from household waste and normal waste, according to local laws and regulations. Please recycle or dispose of this product at end-of-life in accordance with local requirements. For proper treatment, recovery and recycling, please take this product to local collection points where available. Please contact your local authorities for further details of your nearest designated collection point. The separate collection and recycling of this product at the time of disposal will help to conserve natural resources and ensure that this product is recycled in a manner that protects human health and environment. Penalties may be applicable for incorrect disposal of this product, in accordance with national legislation.

3. PACKAGING

The MobilePilot packaging is designed to protect and organize all components required for installation. Inside, you will find the main body of the device, standard fastening elements (screws or Velcro, depending on the model), and the basic accessories for initial assembly.

 Not included items: Some specific components are not included in the basic MobilePilot package and must be purchased separately if required for your type of installation.

INCLUDED IN THE MOBILEPILOT PACKAGING

1 BOX + MOBILEPILOT

3 BATTERY CHARGER

2 USER MANUAL

4 INSTALLATION COMPONENTS





4. MOBILEPILOT INSTALLATION

STEP 1: REMOVAL OF THE PASSIVE STEERING WHEEL

Remove the passive steering wheel from the vessel.

STEP 2: MOUNTING PLATE INSTALLATION

a) If the pump is secured with screws

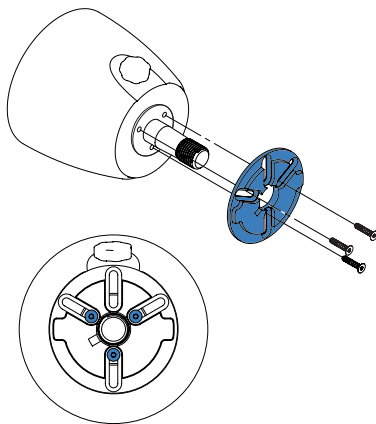
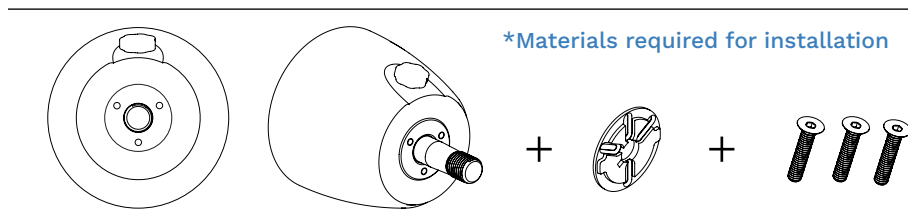

1. Remove the front screws from the pump and set them aside.
2. Insert the mounting plate, ensuring that the slots align with the hole positions.
3. Reinsert the three screws into their respective positions.*
4. Tighten the screws evenly and progressively to ensure proper centering of the mounting plate.

* If the thickness of the mounting plate prevents correct insertion of the original screws, use the screws included in the packaging.

Recommendations

Make sure the plate is properly seated before tightening the screws.

Use the appropriate tool to avoid damaging the threads.

Do not force the screws; tighten them progressively in a criss-cross pattern to ensure even distribution.



b) If the pump has a smooth surface, it will be mounted using adhesive velcro

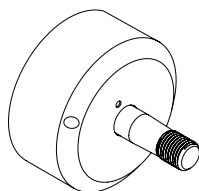
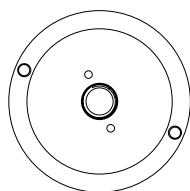

*Materials required for installation

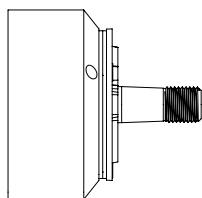
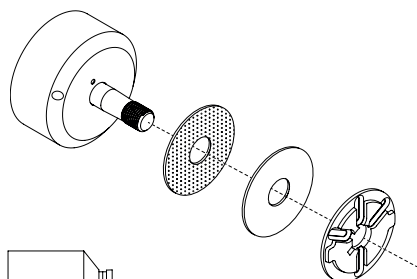
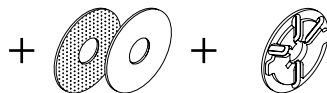

1. Clean the surface at the base of the shaft using alcohol or a similar product. Ensure it is clean and dry before applying the adhesive Velcro.

2. Attach one side of the Velcro, keeping it aligned with the shaft.

3. Attach the other side of the Velcro to the back of the mounting plate, making sure the central holes are aligned.

4. Insert the mounting plate, centering it with the shaft, and secure it using the Velcro so that the notches on the plate are in a horizontal position, as shown in the figure.

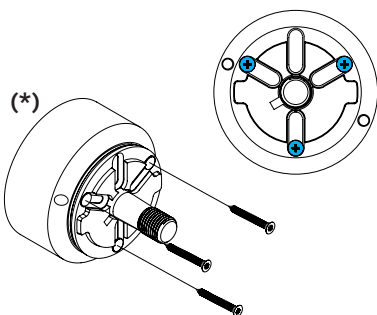

OPTIONAL: If the installation is done over a hollow cover, it can be reinforced with self-tapping screws (). Perform this step only after the full installation is completed and it has been verified that the wheel is perfectly aligned.

Recommendations

Apply even pressure to the adhesive to improve bonding and prevent premature detachment.



STEP 3: SHAFT ADAPTER INSTALLATION

a) Male shaft

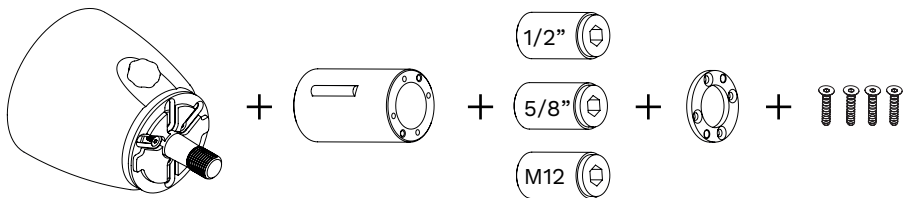

a) Female shaft

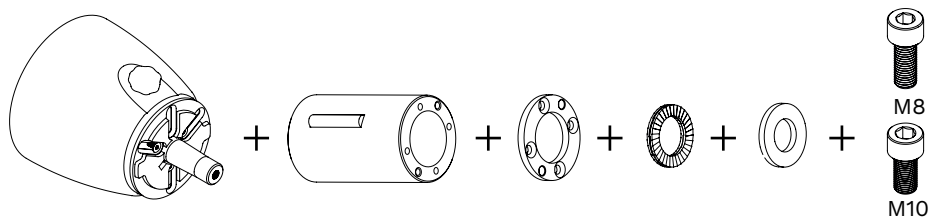

Clean and grease the shaft before starting the process.

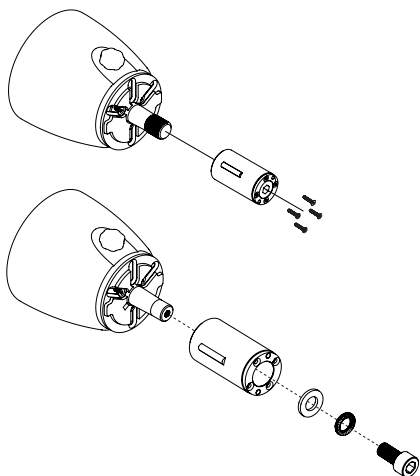

1. Check the thread size of your shaft.

2. If the pre-installed nut does not fit your shaft, follow these steps:

a) Remove the cover of the shaft adapter (attached with 4 screws).

b) Replace the internal thread with the one that fits your shaft (M12, 1/2", or 5/8").

c) Reinstall the adapter cover.

3. Install the adapter onto the shaft using an 8 mm Allen key, tightening the thread firmly onto the shaft.

Recommendations

Use appropriate tools to avoid damaging the thread or the screws and tighten the screws evenly to ensure a secure fit.



STEP 4: MOUNTING THE MOBILEPILOT

1. Align the steering wheel with the shaft and carefully fit it in place. Make sure the key is correctly positioned to allow insertion of the MobilePilot.
2. Position the back of the MobilePilot with the activation button (Fig. 1) facing upward, and ensure it fits properly with the mounting plate installed in Step 2.
3. Once the wheel is fitted, secure it using the two M3 screws that best match your steering system. Make sure to install the washers in the correct order as shown in Figure 2.
4. 4. Tighten the screws evenly to avoid any looseness.

STEP 5: CENTERING TO STRAIGHT COURSE

1. Align the steering wheel with the vessel's heading and fasten it in place. Fine adjustments can be made using the 4 central screws (REF).

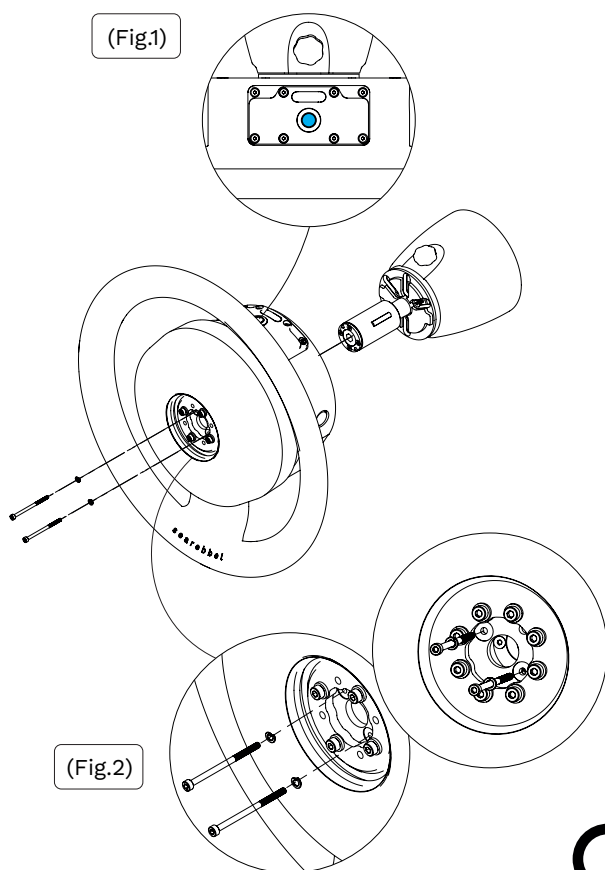



5. NAVIGATING WITH MOBILEPILOT

Operating the MobilePilot Without App or Display

When MobilePilot is used without the mobile app or a linked display, only the heading hold navigation mode is available. Follow the procedure below:

1. Power on MobilePilot

Press the ON button (on the right side of the MobilePilot).

2. Wait for startup sequence

The LED will change from red to flashing blue during system initialization.

3. Ensure minimum speed

For correct setup, the vessel must be moving at more than 1.5 knots. This ensures the GPS receives an accurate position.

4. System ready confirmation

Once the system is ready, the LED will turn solid blue.

5. Activate navigation mode

When the LED is solid blue, press the MobilePilot activation button (at the top).

The LED will turn green, indicating that navigation mode is active.

During operation, the LED will remain green.

6. Deactivate navigation / return to manual control

To deactivate MobilePilot and return to manual steering, press the activation button again.

The LED will return to solid blue, indicating that the system is in standby and ready to be reactivated.

7. Error indicator

If an error occurs, the LED will light up red.

At the end of this manual, you will find a link to the extended manual, where the full table of MobilePilot's audiovisual signals is available.

Advanced Navigation Modes – Searebbel App

To access features such as “Draw Route” or define waypoints, use the Searebbel app, available for iOS and Android.

1. Download the Searebbel app from the app store.

2. Follow the initial setup steps.

3. Once inside the map, tap the Searebbel icon to start defining your route.

4. When ready, select “Start Route”.

More details are available in the extended manual at <https://www.searebbel.com/user-manuals/>



6. NMEA 2000

ES

Configuración de rutas desde la pantalla de la embarcación:

Para poder fijar y gestionar rutas directamente desde la pantalla, es imprescindible la integración mediante NMEA2000. Para ello, es necesaria la instalación de un módulo adicional específico, compatible con el MobilePilot.

Las instrucciones detalladas para esta configuración están disponibles en la web oficial de Searebbel: www.searebbel.com/user-manuals/

EN

Route configuration directly from the boat's display:

To set and manage routes directly from the boat's display, integration via NMEA 2000 is required. This integration requires the installation of an additional dedicated module compatible with the MobilePilot.

Detailed instructions for this configuration are available on Searebbel's official website:
www.searebbel.com/user-manuals/



searebbel