

System variations

AC Concept

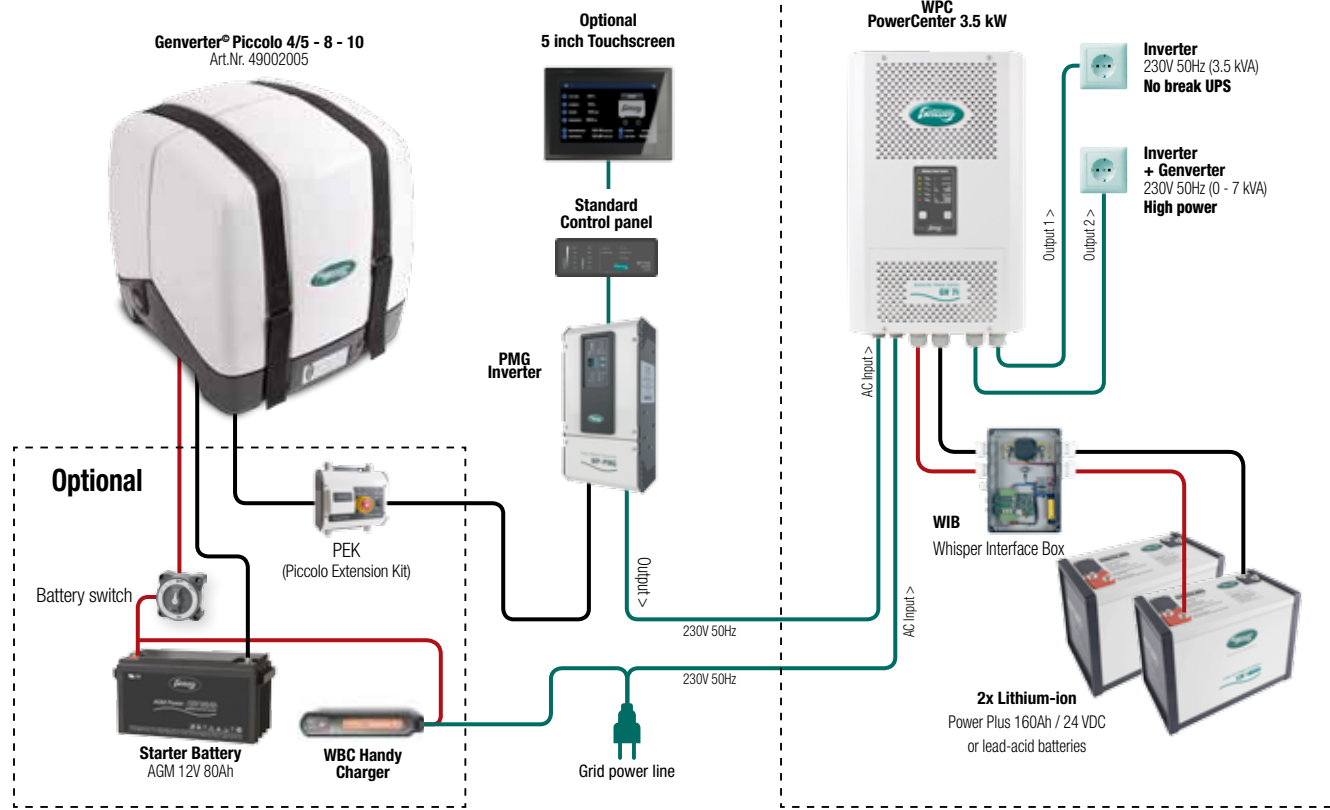

AC Concept
 We offer Genverter AC versions, providing 230 V 50 Hz (110/120 V 50-60 Hz) through the PMG inverter module. 'Raw' energy, which has been generated by the Permanent Magnet alternator, is stabilized to pure sine wave voltage via this cabinet. The PMG is connected to the Genverter® by a three wire cable. See drawing at previous, showing the standard supply and the basic options. By installing a WhisperPower Centre inverter/charger, the Genverter's AC output power can be temporarily increased (by 2-3.5 kW). The PMG output is coupled to the WPC input which feeds the power from the Genverter® to the consumer devices. Whenever the Genverter® experiences too much load, the WPC provides additional power by using the battery. With restricted/ limited use, the Genverter® automatically switches off if set to automatic mode.

DC Concept 24 or 48 VDC

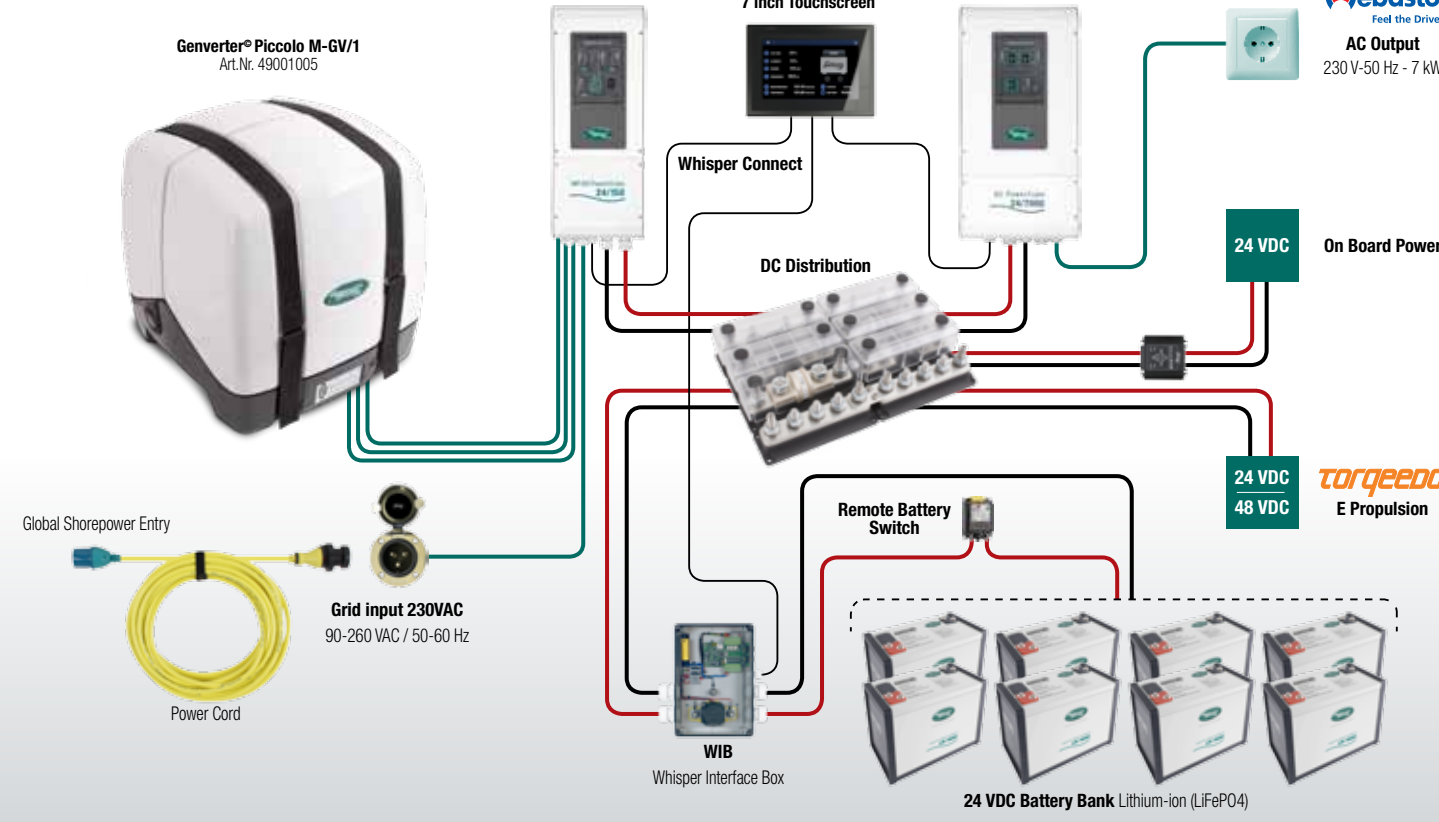

DC Concept
 Another way to compose a system is to take the battery as the main power source together with a DC to AC inverter and let the genverter be the 2e source of power. In this case, the genverter should operate as a battery charger to re-fill the batteries when needed.

Main components of this system:
 - DC PowerCube battery charger / shore power support system. Available for 24 and 48 VDC
 - AC Powercube as the robust inverter, in fact acting as the "generator", available in 4, 7 and 14 kVA powering
 - Battery storage, preferably lithium
 - TOUCH system monitor

This is our "low emission Hybrid power system":
 - A perfect system for on board AC and DC appliances
 - A perfect back-up for electrical propulsion systems

Essential Installation Parts

- ▶ **Waterlock/ silencer**
Water return protection
- ▶ **Water/gas Separator**
For a smooth & silent exhaust system
- ▶ **Hoses and clemis**
supplied in kit form
- ▶ **Syphon breaker kit**
- ▶ **Lubrication oil**
- ▶ **Touch panel (5 inch)**
Ideal remote panel, clear visibility of all functions, includes running hours counter
- ▶ **Base plate kit**
To reinforce the mounting surface
- ▶ **Water inlet kit, fuel filter kit**

Genverter® Piccolo

Piccolo 4/5 | Piccolo 8 | Piccolo 10 | Piccolo 12

Power Generation

Variable Speed Marine Diesel Generators



Sales outlets in more than 50 countries
www.whisperpower.com

Headoffice WhisperPower BV • Kelvinlaan 82 • 9207 JB Drachten • the Netherlands
 Tel: +31 (0) 512 571 550 • Fax: +31 (0) 512 571 599
 sales@whisperpower.com • www.whisperpower.com

WhisperPower sales outlet:



Generating Confidence

Genverter® Piccolo

Silent, Compact, Light-weight and Extremely Powerful

The WhisperPower Genverter® Piccolo range of marine diesel generators are based on modern, ultra compact diesel engines which meet the latest emission standards.

We apply advanced technology as used in e-mobility and renewable energy markets, resulting in the highest efficiency, lowest exhaust emissions and superior electrical output quality in terms of voltage, frequency and peak power behaviour. Our Variable Speed Technology allows to vary operating speed of the engine to match the connected electrical load, so no energy is wasted.

Perfect power for your airconditioning (and more)

All Genverter Piccolo models are supplied with an external inverter "box", so no electronic devices are mounted close to the engine. Our PMG inverter should be mounted in a dry and cool area. Independent of the rotating speed of the Permanent Magnet based alternator, the genverter's PMG delivers the correct power quality for comfort equipment, such as washing machines, air-conditioning, electrical cooking devices and various other AC powered equipment. Sensitive appliances work perfect and are not harmed by a poor power supply.

The perfect fit

- Extremely compact and light weight
- Virtually vibration free
- Indirect water cooling (sea or fresh), stow away principle
- Lowest noise level (from 50 dBA)
- Pure sine wave output 230 VAC, 50 Hz (+/- 0.1 %) or 120 V 60 Hz
- Four models, 4/5, 8, 10 and 12 kVA
- All necessary first class installation parts available
- Easy to install – all engine connections pre-fabricated

Up to date technology

- Highly efficient thanks to use of permanent magnet alternator technology
- Automatic speed settings on load sense (for 1 cylinder models)
- Manual speed settings for optimal rpm level (all models)
- PMG inverter fitted with high current IGBT's for high surge
- Tier 4/ EPA emission level (2/3 Cylinder models) as standard
- Optimal sound reduction by polyester sound shield

Choose from AC or DC variations

- Standard Versions for 230 Volt 50 Hz (100- 120 V 50-60 Hz) devices
- Version for charging the 24 V batteries by connecting to WhisperPower DC PowerCube

Piccolo 4/5, the smallest and most powerful in the world

- Piccolo 4 - 4.4 kVA / 3.5 kW at 3600rpm
- 8 kVA, 36.12.t peak power
- Piccolo 5/ 5 kVA, 4 kW at 3600 rpm
- Piccolo 5 can start a 10,000 BTU A/C and a 16,000 BTU at the same time
- Dimension: 520 x 470 x 450 (h x w x d)
- weight: 58 kg (plus weight of PMG inverter).



Unique engine

The small Piccolo 4/5 models are fitted with a modern diesel designed by WhisperPower, entirely for the purpose of generating power the smooth way. The oil is cooled by a heat exchanger designed for indirect watercooling, the circulation water pump is driven by a PTO (no belt). Our Piccolo 8 and 10 kVA models are all-water cooled, back-end and diesel, in one circuit.

Quiet & vibration free

Vibrations are just as irritating as an over noisy diesel engine. The customized shock mounts, combined with the sound enclosure, result in a super silent and virtually vibration free set-up. All parts needed to be serviced are located at one side of the Genverter. Picture: detail of our WhisperPower WP 1 diesel engine.

Highest power quality

Devices such as air conditioning units and electric motors are often controlled by electronics to improve the efficiency and performance. Traditional generators may fail to operate these appliances. All Piccolo models are equipped with a PMG module (Power Module Genverter®) to ensure that the voltage and frequency within the rotating speed range remain perfect so that all the equipment continues to run without interruption. Surge power is generated by the PMG to start up inductive loads.



Any space will do

All our Piccolo models are extremely compact and can be installed in the smallest location. Only minor air ventilation is needed. At picture an installation of a Piccolo 4 in a day cruiser



Ease of installation

All installation parts are available in kit form ensuring an fast and easy job to do. Not a single part or component is needed, all are included.

Complete energy system

At the back side of this brochure you will find a complete electrical power system including a Combi inverter/charger, batteries, shore power connection, monitoring etc. This is our great service to you as our customer: we offer complete single brand solutions for the complete on board electrical power system. Everything from one hand. If needed supplied with DC distribution/digital switching, our TOUCH Plus system.



	PICCOLO 4/5	PICCOLO 8	PICCOLO 10	PICCOLO 12
	49002005 standard, wet exhaust - 230V / 50 Hz 49002006 ungrounded, wet exhaust 49012005 automatic rpm control 49002055 Piccolo 4 - 120 V / 60 Hz 49003005 Piccolo 5 - 230 V / 50 Hz *	49005005 standard, wet exhaust - 230 V / 50 Hz 49005055 standard, wet exhaust - 120 V / 60 Hz For other versions: See M-GV 8 (WhisperPowerBook)	49009005 standard, wet exhaust - 230 V / 50 Hz 49009055 standard, wet exhaust - 120 V / 60 Hz For other versions: See M-GV 8 (WhisperPowerBook)	49006005 standard, wet exhaust - 230 V / 50 Hz 49006055 standard, wet exhaust - 120 V / 60 Hz For other versions: See M-GV 8 (WhisperPowerBook)
MAIN SPECIFICATIONS				
Output power (Max) at 3600 rpm	4 kW / 4.4 kVA	6 kW / 8 kVA	8 kW / 10 kVA	10 kW / 12 kVA
Intermittent Power	3.5 kW**	6.5 kW	8.5 kW	10 kW
Continuous Power at 3000 rpm	3 kW	6 kW	8 kW	8 kW
Noise level	54 dB(A) at 7 m, 65 dB(A) at 1 m	51 dB(A) at 7 m, 60 dB(A) at 1 m	51 dB(A) at 7 m, 60 dB(A) at 1 m	54 dB(A) at 7 m, 65 dB(A) at 1 m
Rpm range	2400 .. 3600 rpm adjustable or automatic	2200 .. 2800 rpm, adjustable	2200 .. 2800 rpm, adjustable	2200 .. 3600 rpm, adjustable
Generator	Permanent Magnet Alternator (PMA)	Permanent Magnet Alternator (PMA)	Permanent Magnet Alternator (PMA)	Permanent Magnet Alternator (PMA)
Inverter Module	WP-PMG frame 1 or frame 1 Plus (Piccolo 5)	WP-PMG frame 1 Plus	WP-PMG frame 2	WP-PMG frame 2
Nominal voltage / frequency	230 V / 50 Hz, (or 120 V / 60 Hz)	230 V / 50 Hz, (or 120 V / 60 Hz)	230 V / 50 Hz, (or 120 V / 60 Hz)	230 V / 50 Hz, (or 120 V / 60 Hz)
Peak power 2 s	200%	200%	200%	200%
Harmonic distortion	< 5%	< 3%	< 3%	< 3%
Frequency tolerance	± 0.1%	± 0.1%	± 0.1%	± 0.1%
DIESEL ENGINE SPECIFICATIONS				
Engine	WhisperPower WP1	Kubota Z482 (Mitsubishi optional)	Kubota D722 (Mitsubishi optional)	Kubota D722 (Mitsubishi optional)
Cylinder volume	309 cc (one cylinder)	479 cc (two cylinder)	719 cc (three cylinder)	719 cc (three cylinder)
Bore & stroke	78 x 76 mm	67 x 68 mm	67 x 68 mm	67 x 68 mm
Air consumption	< 0.42 m³/min	< 0.95 m³/min	< 1.22 m³/min	< 1.22 m³/min
Cooling system	indirect	indirect (keel cooling closed)	indirect (keel cooling closed)	indirect (keel cooling closed)
Fuel consumption (no load - full load)	0.8-1.2 l/hr	1.2-2.5 l/hr	1.2-3 l/hr	1.2-3 l/hr
Starter battery charge current	charger 12 V/7A	alternator 12 V/12.5 A	alternator 12 V/12.5 A	alternator 12 V/12.5 A
DIMENSIONS & WEIGHT				
Length x width x height (cabinet)	450 x 461 x 520 mm	660 x 550 x 622 mm	740 x 550 x 622 mm	740 x 550 x 622 mm
Length x width x depth (PMG)	420 x 196 x 148 mm	420 x 196 x 148 mm	451 x 200 x 174 mm	451 x 200 x 174 mm
Dry weight (cabinet + PMG)	58 kg + 7 kg	155 kg + 9.9 kg	175 kg + 9.9 kg	175 kg + 9.9 kg
Dry exhaust / wet exhaust	Ø 1 inch BSP / Ø 40 mm	Ø 1 inch BSP / Ø 40 mm	Ø 1 inch BSP / Ø 40 mm	Ø 1 inch BSP / Ø 40 mm
Oil dipstick	service side	top and side	top and side	top and side
Max. operating angle	25° in all directions	25° in all directions	25° in all directions	25° in all directions
CONTROL PANEL				
Standard	start / stop panel	start / stop panel	start / stop panel	start / stop panel
Optional	2 nd start/stop panel, Touch panel	2 nd start/stop panel, Touch panel	2 nd start/stop panel, Touch panel	2 nd start/stop panel, Touch panel
CABEL EXTENSION				
60201470	PEK (Piccolo extension kit)	PEK (Piccolo extension kit)	PEK (Piccolo extension kit)	PEK (Piccolo extension kit)

*) Our Piccolo 5 is a new model, fitted with a more powerful PMG inverter, capable to deliver a very high peakpower without distortion of the sine wave and disturbance of the frequency. Ideal to operate A/C units of various brands. The Webasto Blue Cool S10 (10.000 BTU) and S16 (16.000 BTU) for example can be started and operated at the same time.

***) 3 kW for 120 V / 60 Hz version



WhisperPower's main manufacturing facility is located in Drachten (Friesland), the Netherlands. Our entire operation and processes conform to ISO 9001-2008 standards. A significant number of our WhisperPower diesel generators are also certified to various national standards, for example Chinese and Russian Maritime Type Approvals due to the strict investigative procedures and regulations for compliance such as audits that can be carried out by third party officials.

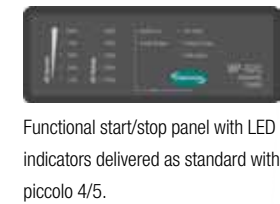
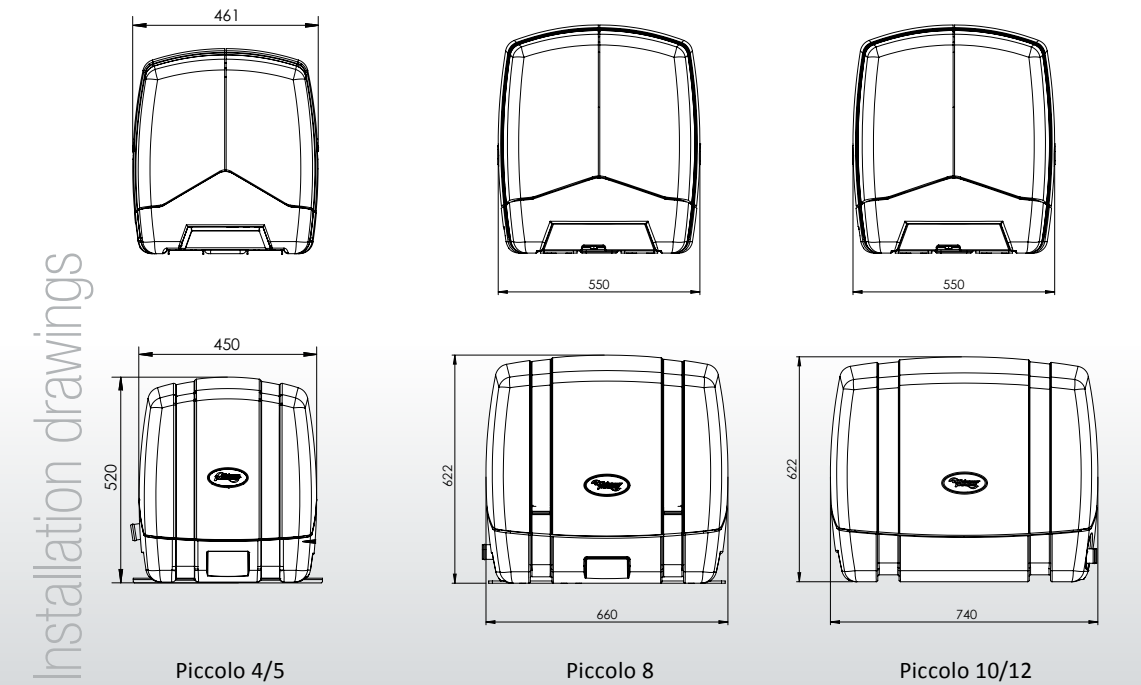

Functional start/stop panel with LED indicators delivered as standard with piccolo 4/5.



5 inch Touch panel, optional. Art. Nr. 40280105



"With the excellent advice, the fast delivery and the very simple installation, Whisper Power convinced us with the Piccolo. This little, quiet Genverter is an excellent fit for the needs of our customers."

Uli and Nils Schürg, Blue Yachting



Allures 39.9 Copyright: Nils Schürg